

**KEY NOTES**

- 01 Metal Deck
- 09 Roof Structure
- 22 Polyisocyanurate Insulation (Fastened or Adhered)
- 25 Compressible Insulation
- 27 Substrate Board (Fastened)
- 28 Cover Board (Adhered)
- 31 Approved Base Ply Sheet
- 36 Base Sheet Liner
- 37 Approved Base Sheet (Adhered)
- 45 Roofing Mastic
- 49 Flexible Vapor Retarder Serving as Insulation Retainer
- 53 AlphaGuard PUMA Base Coat
- 61 AlphaGuard Glass Mat or Permafab
- 73 AlphaGuard PUMA Top Coat
- 91 Wood Blocking
- 95 Cant Strip
- 97 Wood Curb Assembly, Slope to One Side
- 108 Sheet Metal Expansion Joint Cover

AlphaGuard® PUMA Plus Expansion Joint, Temp. Roof, Metal Deck  
 Detail 34081

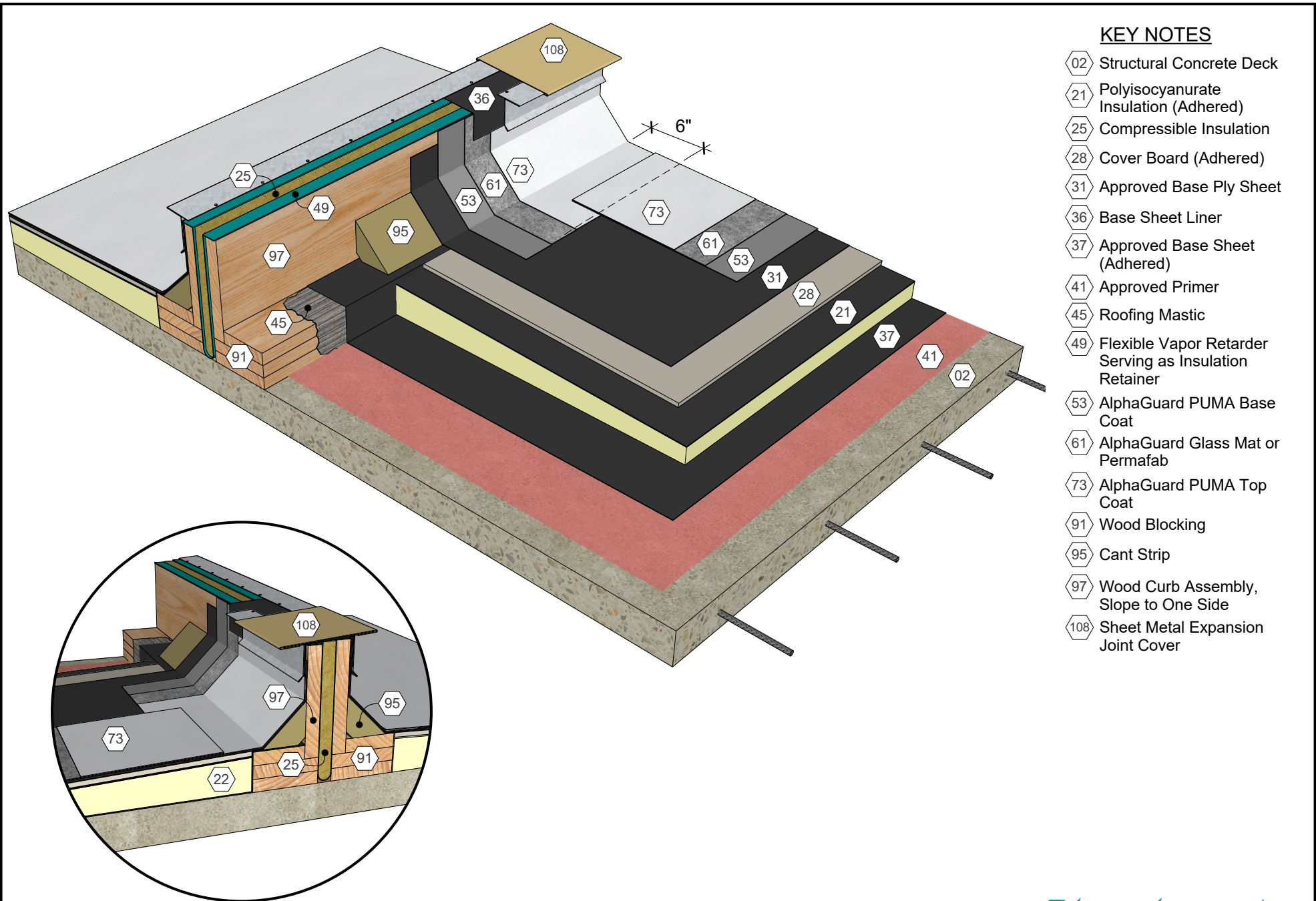

**KEY NOTES**

- 02 Structural Concrete Deck
- 21 Polyisocyanurate Insulation (Adhered)
- 25 Compressible Insulation
- 28 Cover Board (Adhered)
- 31 Approved Base Ply Sheet
- 36 Base Sheet Liner
- 37 Approved Base Sheet (Adhered)
- 41 Approved Primer
- 45 Roofing Mastic
- 49 Flexible Vapor Retarder Serving as Insulation Retainer
- 53 AlphaGuard PUMA Base Coat
- 61 AlphaGuard Glass Mat or Permafab
- 73 AlphaGuard PUMA Top Coat
- 91 Wood Blocking
- 95 Cant Strip
- 97 Wood Curb Assembly, Slope to One Side
- 108 Sheet Metal Expansion Joint Cover

AlphaGuard® PUMA Plus Expansion Joint, Temp. Roof, Structural Concrete Deck  
Detail 34082

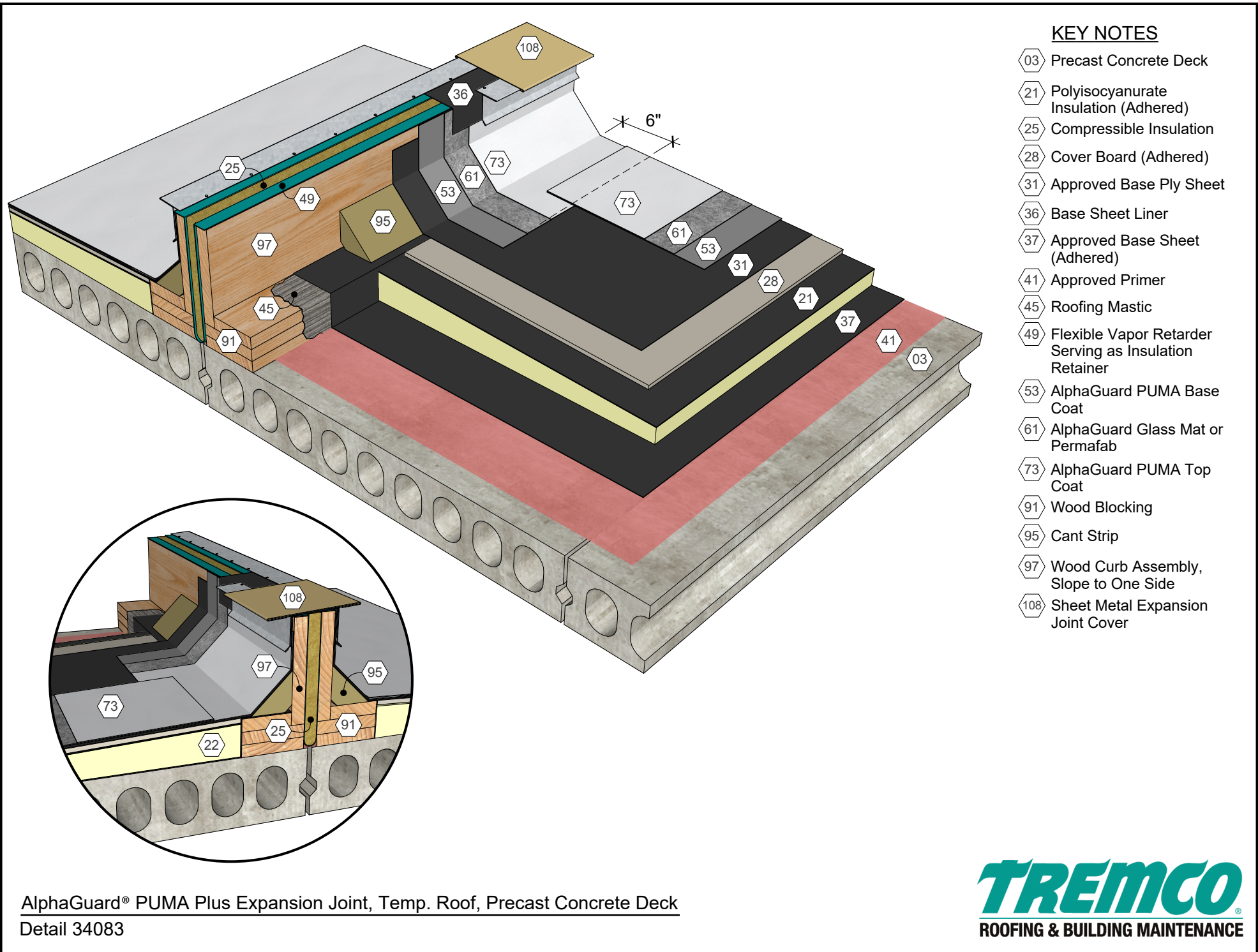

**KEY NOTES**

- 03 Precast Concrete Deck
- 21 Polyisocyanurate Insulation (Adhered)
- 25 Compressible Insulation
- 28 Cover Board (Adhered)
- 31 Approved Base Ply Sheet
- 36 Base Sheet Liner
- 37 Approved Base Sheet (Adhered)
- 41 Approved Primer
- 45 Roofing Mastic
- 49 Flexible Vapor Retarder Serving as Insulation Retainer
- 53 AlphaGuard PUMA Base Coat
- 61 AlphaGuard Glass Mat or Permafab
- 73 AlphaGuard PUMA Top Coat
- 91 Wood Blocking
- 95 Cant Strip
- 97 Wood Curb Assembly, Slope to One Side
- 108 Sheet Metal Expansion Joint Cover

AlphaGuard® PUMA Plus Expansion Joint, Temp. Roof, Precast Concrete Deck  
 Detail 34083



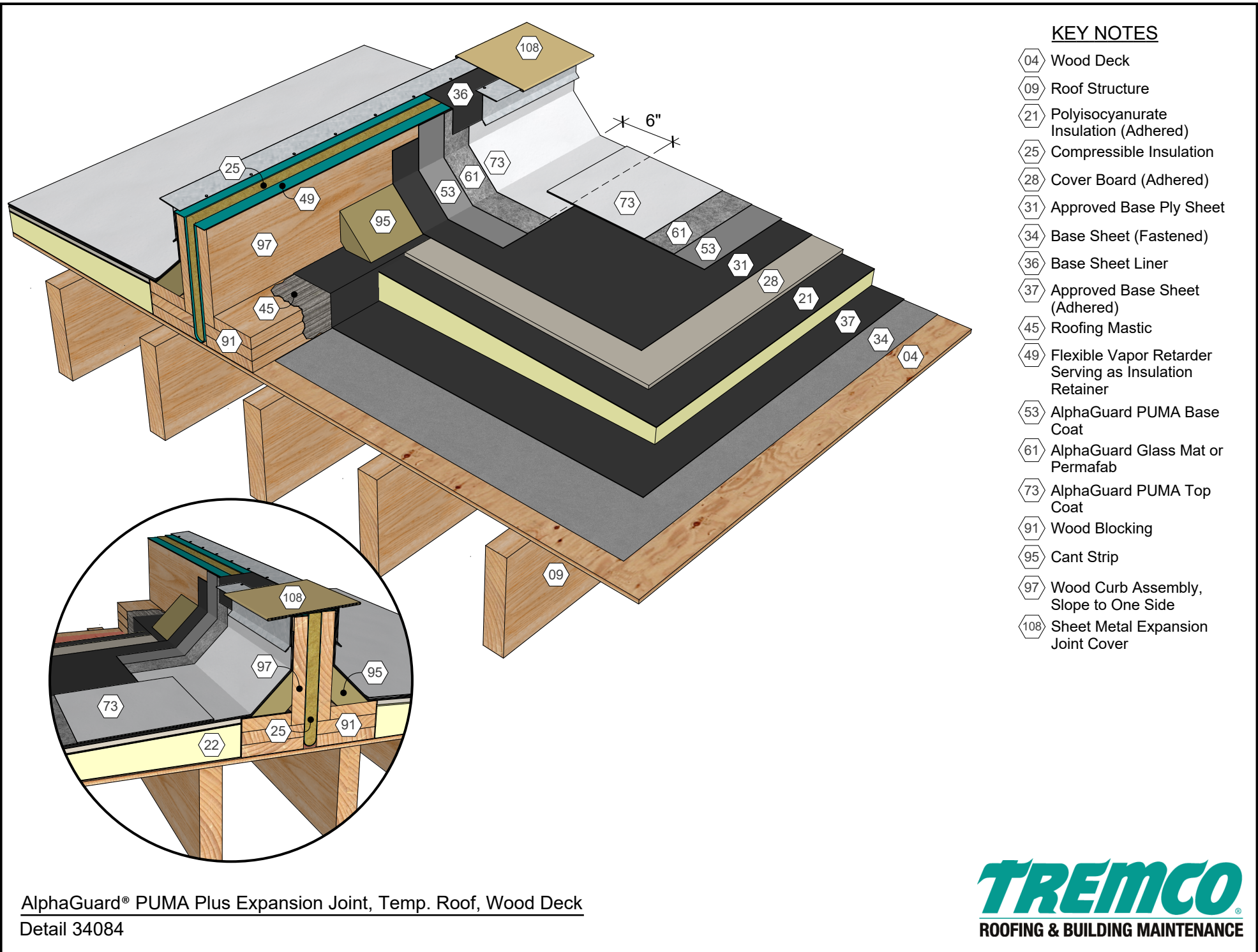

**KEY NOTES**

- 04 Wood Deck
- 09 Roof Structure
- 21 Polyisocyanurate Insulation (Adhered)
- 25 Compressible Insulation
- 28 Cover Board (Adhered)
- 31 Approved Base Ply Sheet
- 34 Base Sheet (Fastened)
- 36 Base Sheet Liner
- 37 Approved Base Sheet (Adhered)
- 45 Roofing Mastic
- 49 Flexible Vapor Retarder Serving as Insulation Retainer
- 53 AlphaGuard PUMA Base Coat
- 61 AlphaGuard Glass Mat or Permafab
- 73 AlphaGuard PUMA Top Coat
- 91 Wood Blocking
- 95 Cant Strip
- 97 Wood Curb Assembly, Slope to One Side
- 108 Sheet Metal Expansion Joint Cover

AlphaGuard® PUMA Plus Expansion Joint, Temp. Roof, Wood Deck  
 Detail 34084



